

Introduction

This guide will help you configure collections. You will be able to set splits and expenses.

Pre-Installation Requirements

Before beginning the installation, ensure that the following requirements are met:

AC Location Activation

The game machine asset and MobileMech device must be assigned to an available location name under your organization in the Amusement Connect Operator Dashboard. Complete the [Location Setup Request Form](#) if a new location needs to be created.

Game Machine Asset Setup

To properly function after installation, the powered MobileMech device must be assigned to an active Game Machine Asset within the Operator Dashboard. To create a new Game Machine Asset, follow the Quick Start Guide process.

Connectivity

Wi-Fi configuration requires access to the router SSID and password. A 2.4 GHZ network is required to connect the MobileMech device to Wi-Fi.

Collections/Splits Set-Up

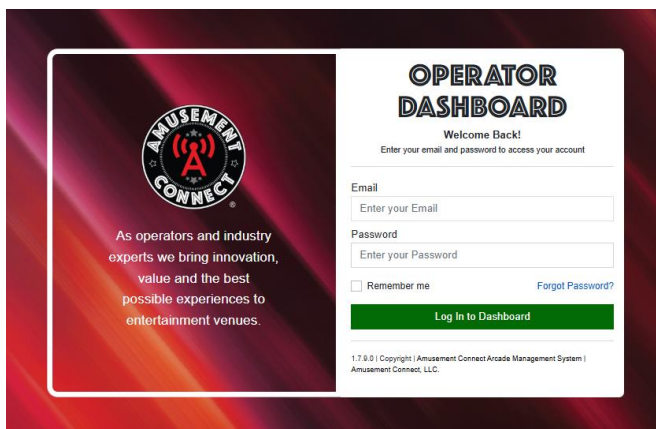

1) Log-in to operator dashboard.
app.amusementconnect.com

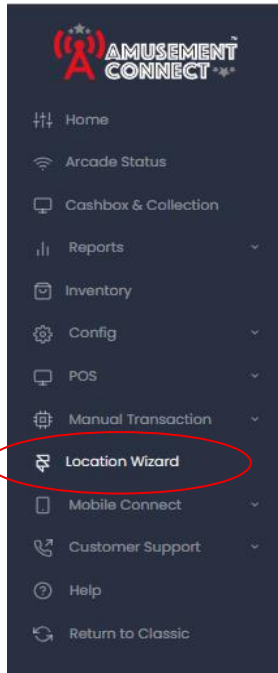

2) Select Location Wizard and select the location you are working with from the list.

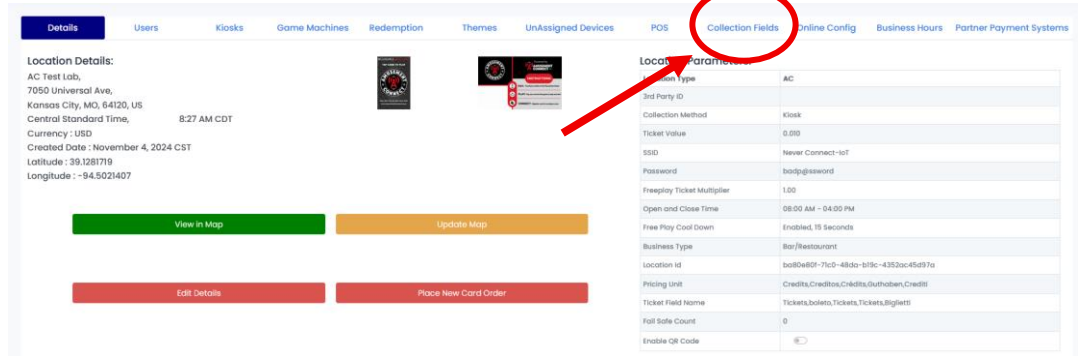

3) Select Collection Fields

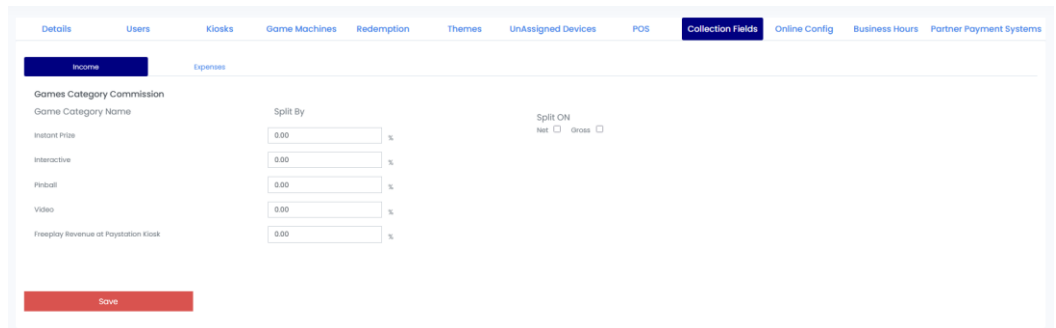

4) Here we enter the percentage splits for each game category. We can also set if the split is based on the Net or Gross. Click Save

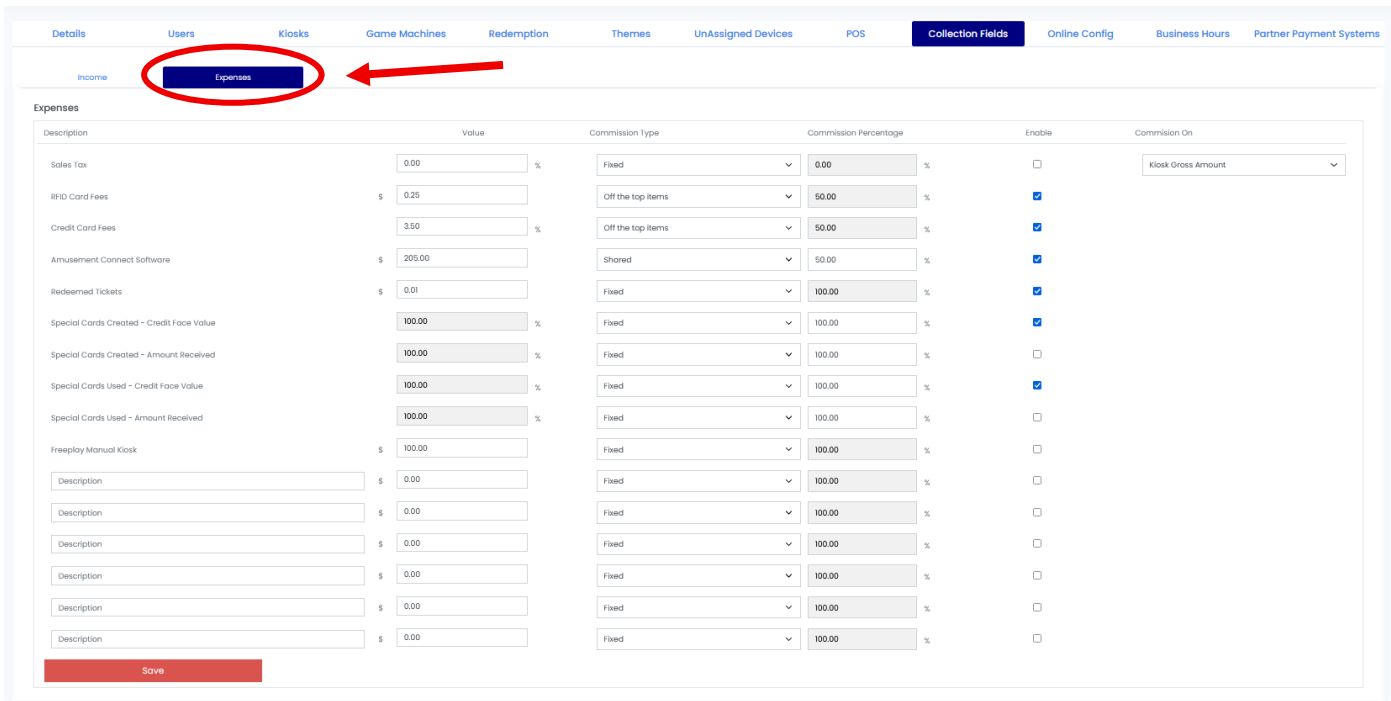

5) Select expenses. Here we can set any expense splits. Click Save